

SLIPON FLANGE

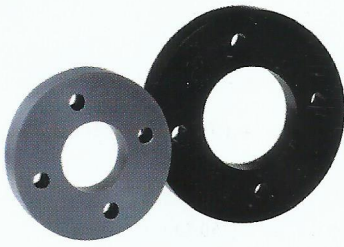

AVAILABLE M.O.C. :

PP (POLYPROPYLENE)
 HDPE (HIGH DENSITY POLYETHYLENE)
 ISOTACTIC PP
 PVDF (POLYVINYLIDENE FLUORIDE)

* FLANGE DRILLED

ANSI B 16.5 (150 CLASS)
 BS 10 TABLE D
 BS 10 TABLE E
 BS 10 TABLE F
 DIN. STD

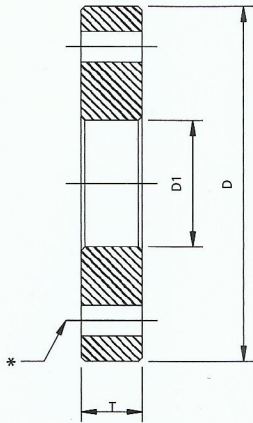

ALL DIMENSIONS ARE IN MM (±2 MM)

SIZE		Ø D	Ø D1	T
IN.	MM.			
½ "	20	95.0	25.5	16.0
¾ "	25	101.0	32.0	17.5
1 "	32	122.5	37.0	18.5
1 ½ "	40	134.0	47.0	19.0
1 ¼ "	50	140.0	57.0	21.0
2 "	63	164.0	70.0	21.0
2 ½ "	75	184.0	83.0	21.0
3 "	90	202.5	97.5	22.0
4 "	110	228.0	118.0	22.5
5 "	125	266.0	133.0	23.0
5 ¼ "	140	263.0	145.0	24.5
6 "	160	298.5	167.0	25.5
7 "	180	329.0	188.0	27.0
8 "	200	375.0	207.5	30.0
9 "	225	398.0	233.0	32.5
10 "	250	427.0	257.0	30.5
11 "	280	451.0	287.0	32.0
12 "	315	489.0	325.0	29.0

AS PER IS : 8008 - 1976 (PART VII)
 MAX. WORKING PRESSURE 10kg / cm²

Note :

We will also provide in M.O.C.: PVDF/PP-H
 & P.P.C.P. Natural, for details & Prices Contact us.